

| Competition

경기도 전곡선사박물관 국제현상설계

International Competition for Gyeonggi-do Jeongok Prehistory Museum

4 4 ' (- /) ' , . 11 21 48 346 가 , UIA 8 1 , 2 1 , 3 2 , 5 , 31 . 4 17 2 가 40 .

- 1 : X-TU Architects(France)
- 2 : Paul Preissner(USA)

- 3 : Lann Combs(USA), Satoshi Matsuoka + Yuki Tamura(Japan)
- 4 : Amedeo Schiattarella(Italy), Stephane Lagre (France), Lars Spuybroek(Netherlands), Antoine Chaudemanche(France), Adriano De Gioannis(Italy)
- Byung Hyun Kim, architect(Korea)
- Kerl Yoo, architect(Korea)
- Sungjung Chough, architect(Korea)
- Ishiyama Osamu, architect(Japan)
- Hani Rashid, architect(USA)
- Cesare Maria Casati, President of ARCA Publications(Italy)
- Roberto Simon, architect(Brazil) representing UIA
- Alternate : Anca Bratuleanu, Professor(Romania)

• : 031-288-5447, www.jeongokmuseum.org,

FUNCTION/SPACE	Area(m ²)	%
Exhibition	1,650	33%
Archive / Storage	500	10%
Curatorial	350	7%
Administration	150	3%
Educational	300	6%
Public amenity	250	5%
Mechanical & Electrical Equipment	400	8%
Circulation	1,200	24%
Special Function *	200	4%
Total	5,000	100%

*Speical Function indicates the space allowed for any use to enforce applicant's intention.

**5% variation in Total, and 10% variation in each FUNCTION/SPACE is allowed.



경기도 전곡선사박물관 국제현상설계
International Competition for Gyeonggi-do Jeongok Prehistory Museum

/ nicdas desmazieres + anouk
legendre / x-tu architects(France)

Space Program

- public amenity 250m²
- exposition 1,650m²
- special function 200m²
- Curatorial 350m²
- administration 150m²
- educational 300m²
- mechanical & electrical equipment 350m²
- archive / storage 500m²
- circulation / toilets / stairs etc 1,250m²

On the river side, in a winding landscape, a bridge stretched between two cliffs, a threshold, a bridge spanning a precipice ...

We wished to honour the riverside landscape which saw the birth of the first inhabitants of Korea, and acknowledge the beauty of the two hill curves echoing the river meanders. How to enhance such a pre-existent form and its geological underground chasm?

- by digging the chasm to let the Earth tell its history
- by alleviating the visual hold of the project in order to let the chasm express itself ;
- for this purpose, the building will be enchased into the hill which has been hollowed out and the stock-rooms will be located underground ;

- by curving the central part of the building so as to unveil the geological crack (and also the sun, from the edge of the crack) ;

- by clothing it in a 《 shimmering skin 》 which will reflect the precipice from underneath.

Thus set up, the project appears like a bridge stretched between two cliffs which can be seen from a long distance from the motorway.

The precipice as a natural threshold and the emotion it induces, will be used to realize a symbolic threshold

into the <prehistoric era 》 which will also give access to the 《 prehistory park 》 ;

Then we create paths, many paths around the curves of the project and of the cliffs, because the paths which were made by the animals going down to the

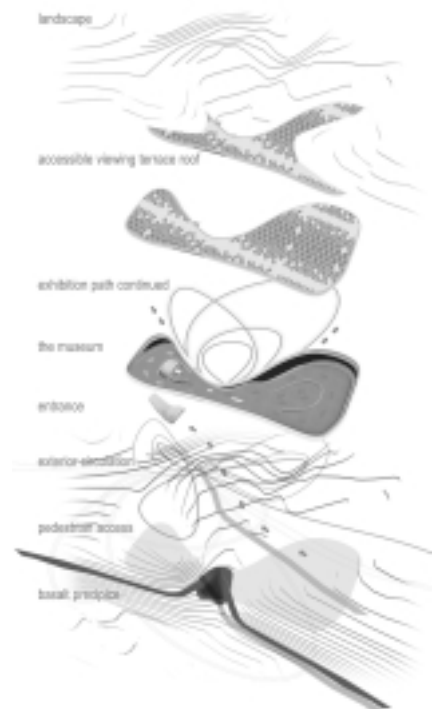

Concept

river to drink, belonged to the « first human beings » landscape.

An immaterial-abstract-shaped « time vessel » :

We want to travel through history !

We wished the visitors to live an

experience, to meet primitive mankind and to be introduced into a world different from everyday life, nearer the landscape than the building.

Paleolithic men were not living like us in standardized built places. They kept

moving in the landscape, the forests, the stream valleys, the delta marshes of which they knew every meander. The rocks and the bare ground were their everyday life, as familiar to them as the house floor to us. 田

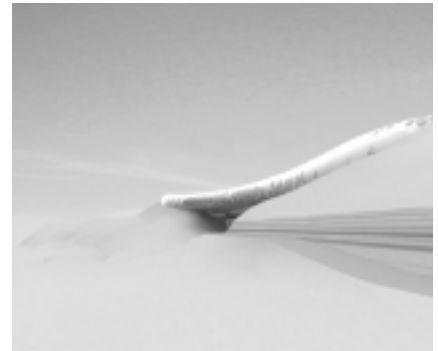
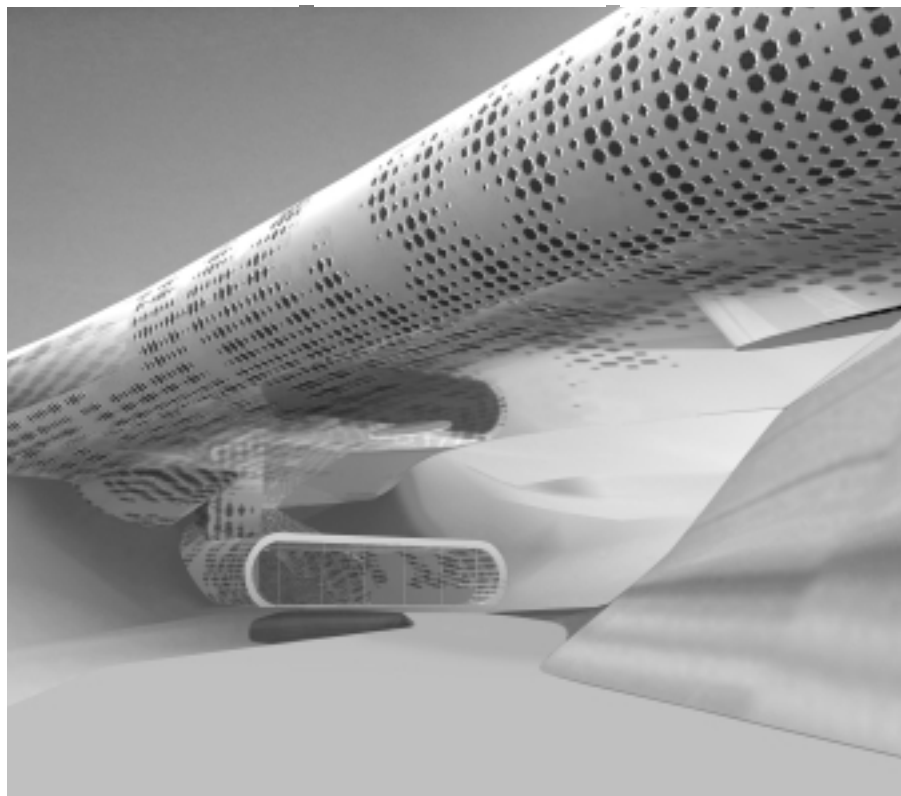
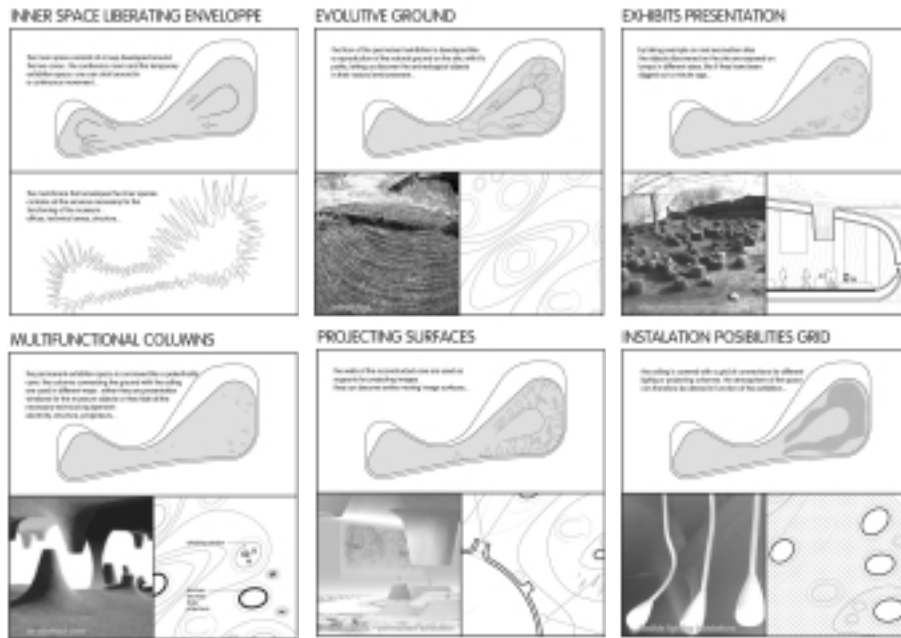

경기도 전곡선사박물관 국제현상설계
International Competition for Gyeonggi-do Jeongok Prehistory Museum

2 / Paul Preissner / Qua'Virarch(USA)

Space Program

administration 397m²

exhibition space 1,916m²

Storage 1,674m²

public amenity 478m²

curatorial 278m²

education 330m²

multi-purpose hall 195m²

DESIGN CONCEPT

The Gyeonggi-Do Jeongok Prehistory Museum is envisaged as an extension of the surrounding terrain and archival sites, and as a fibrous volume, which emerges from itself, expanding onto the site, ferociously changing from a soft and natural surface (terrain) into a strong and foreign material (building).

Using a policy to promote cultural and educational activities, our proposal performs as a central character in the play, not only for the users of the facility, but also for the entire culture of Korea; becoming a new Center for the discovery and empathetic learning of history.

The concept for museums of cultural prehistory, particularly those that organizational framing in the process of research, have changed. Our design proposes an open interconnected terracing of exhibition spaces. All rooms of exhibition are separated only through the platform circulation, while visibility is constantly maintained. This new form of curatorial framing allows the entire contents of the museum to be constantly appreciated from every position, reinforcing the magnitude of historical artifacts contained within.

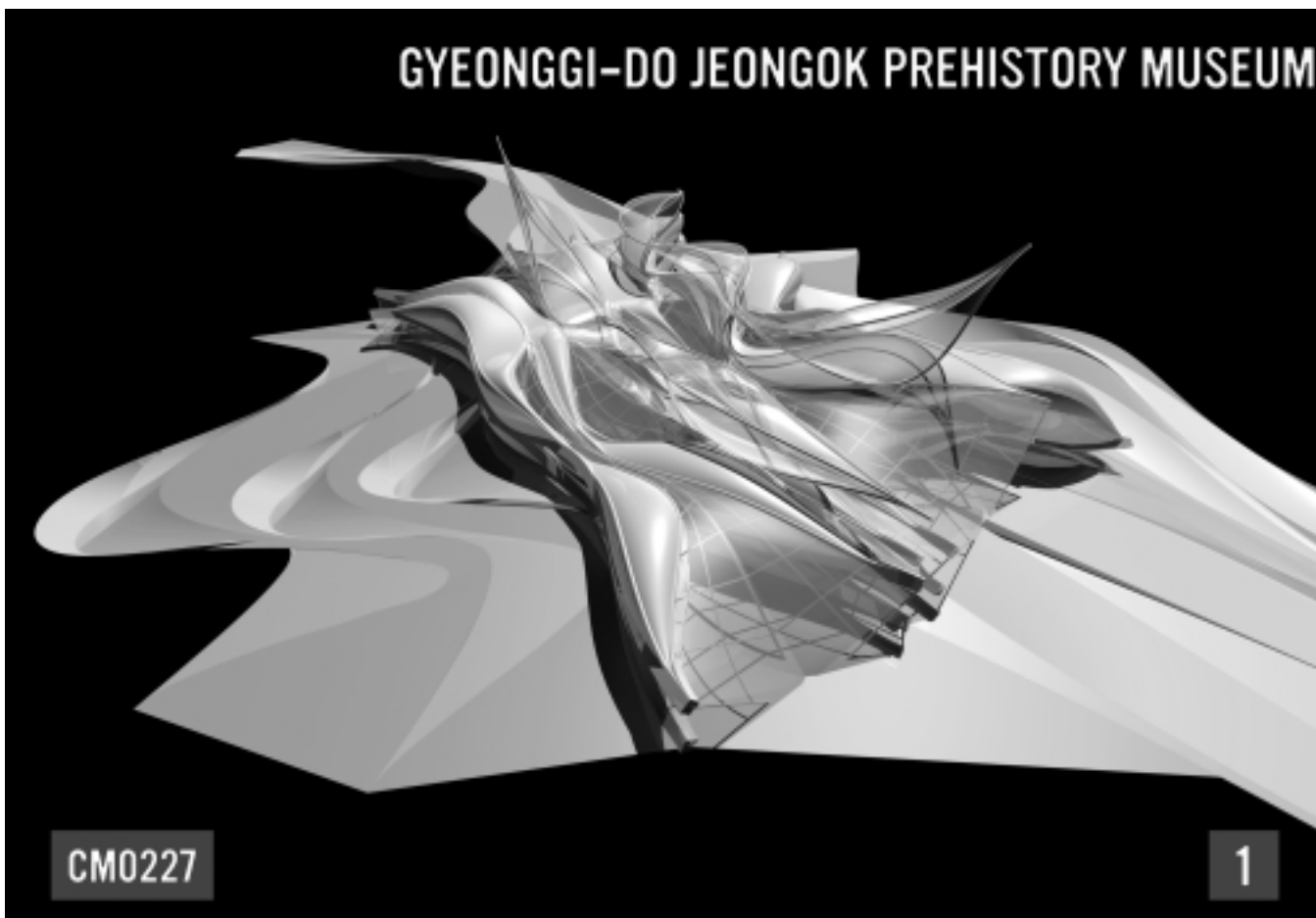

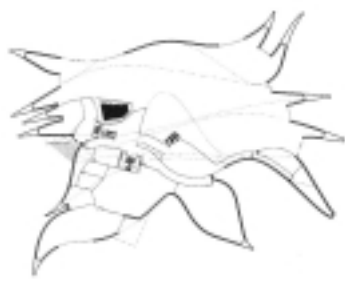

b1 plan



1f plan



2f plan

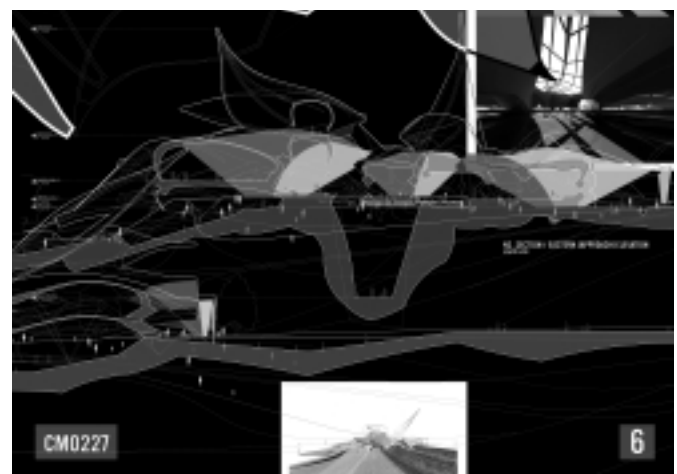
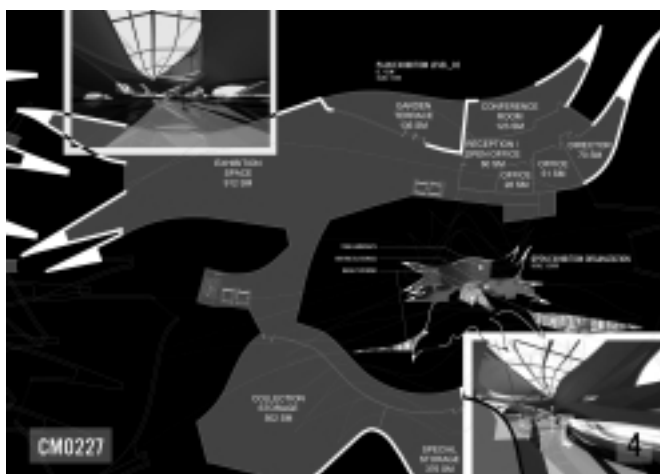
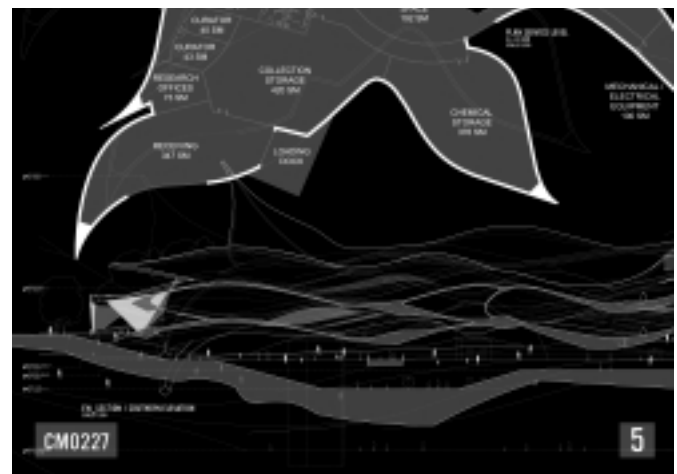
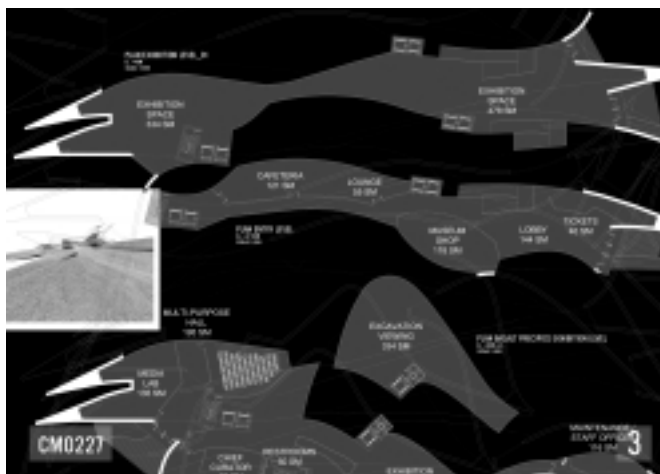
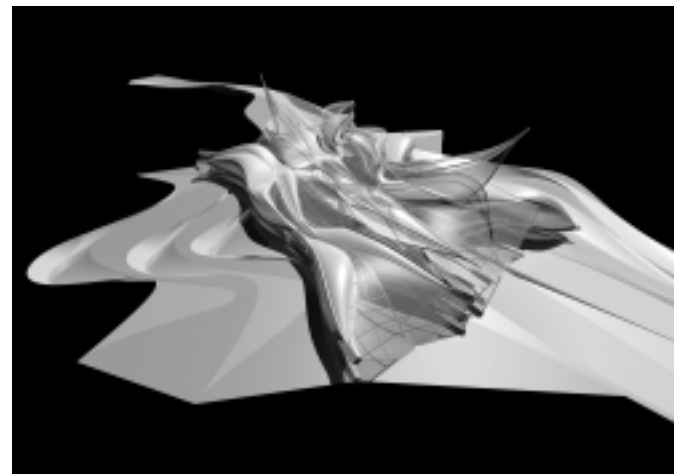
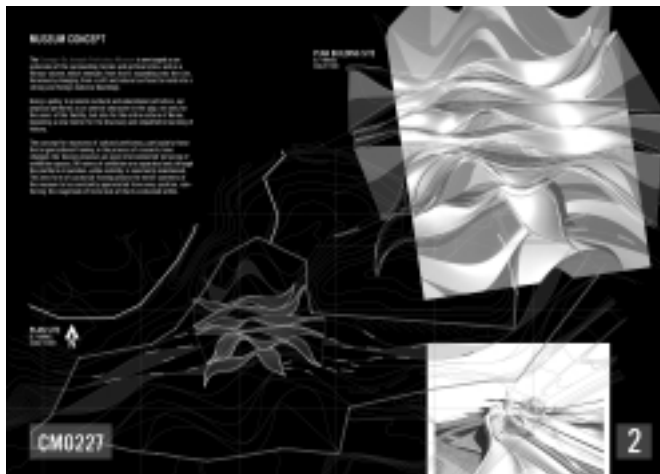

경기도 전곡선사박물관 국제현상설계
International Competition for Gyeonggi-do Jeongok Prehistory Museum

3 / Ionn Combs / easton +
combs architects(USA)

Space Program
 exhibition 1,800m²
 archive / storage 420m²
 Curatorial 370m²
 administration 130m²
 educational 320m²
 public amenity 240m²
 m & e equipment 300m²
 circulation 1,420m²
 special function 190m²

Acceptance Form of Promoter's Terms
 I(We), the undersigned competitor(s),
 accept the terms of the Promoter, the
 Organizing Committee for the Gyeonggi-
 do Jeongok Prehistory Museum affiliated
 to the Gyeonggi Provincial Government,
 written below :

1. The Competitor abides by the decision
of the Promoter.
2. The Promoter, the Organizing
Committee for the Gyeonggi-do
Jeongok Prehistory Museum, retains
the ownership of the submitted design.

3. The Competitor retains the authorship of
the submitted design.
4. The Competitor, in submitting an entry,
agrees to permit the Promoter, the
Organizing Committee for the
Gyeonggi-do Jeongok Prehistory
Museum, to exhibit, publish or otherwise
publicize the submitted design in the
media.

Two vectors of consciousness intersect in
this proposal. establishing a conceptual
relationship between two distinct ideas
about scale and time.

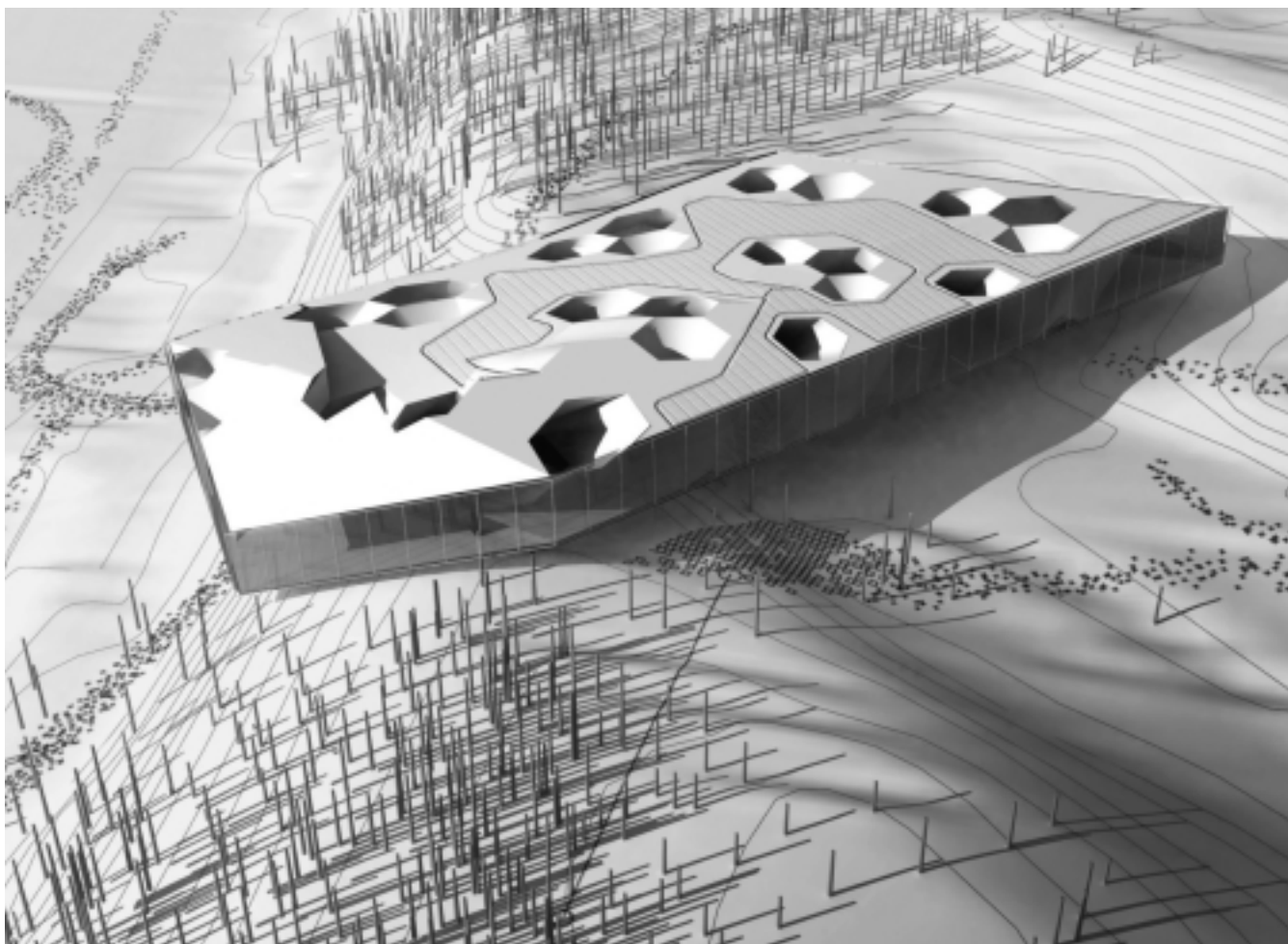



Building plan : main Level



site plan

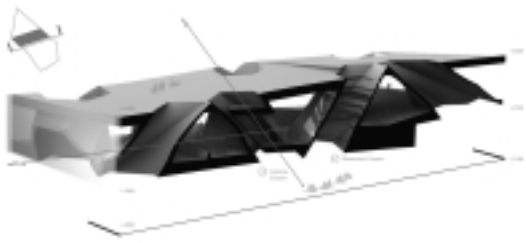

section through exhibition hall showing collections chambers

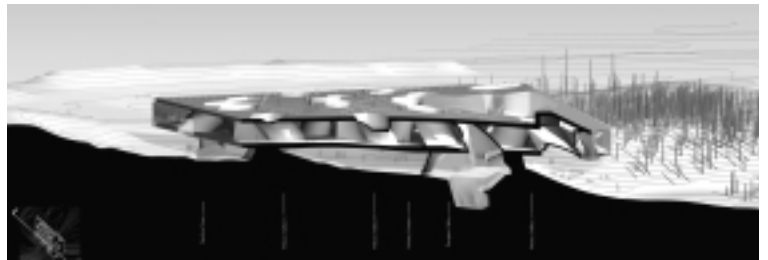

site sectional perspective

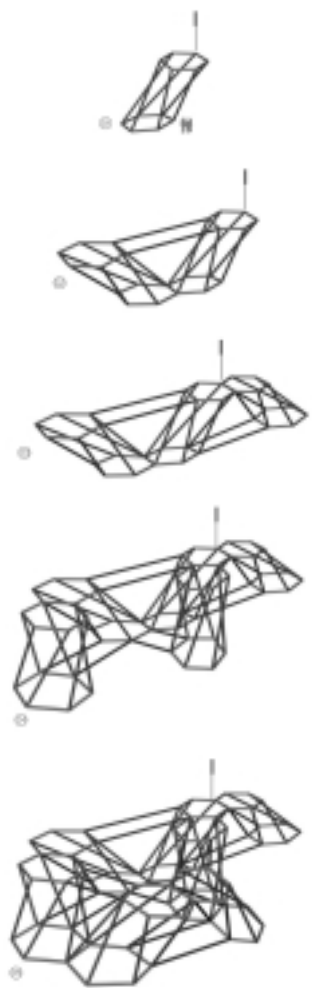
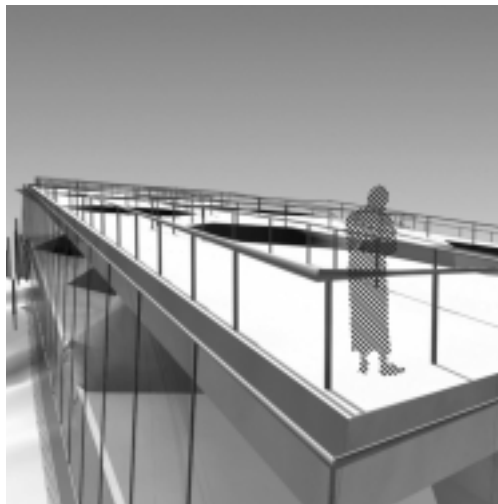
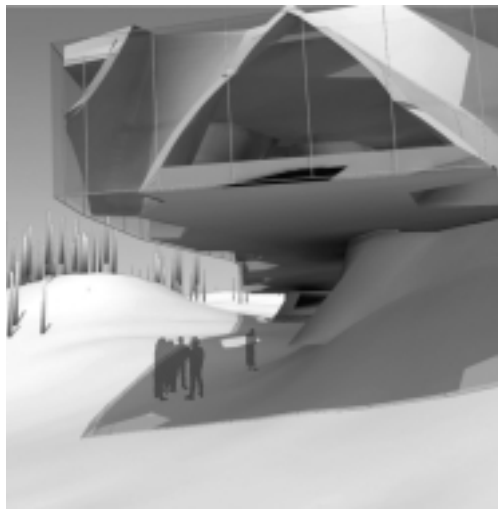
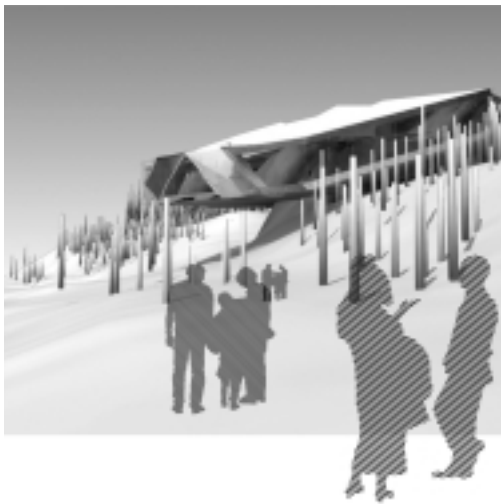

torqued structural unit composite strategy

3 / Satoshi matsuoka + yuki tamura /
matsuokasaoshitamurayuki(Japan)

Space Program

exhibition 902.5m²
archive / storage 559.5m²
curatorial 254m²
administration 166m²
educational 454m²
public amenity 219m²
mechanical & electrical equipment 261m²
circulation 1,216m²
special function 215.5m²

The site is located in the center of the wide-area masterplan including Prehistoric Site, Outdoor Exhibition, Amusement Park, History Culture Village. We propose to transform the location into an interpark where it is a connecting point for the visitors and a destination for the residents. From the surrounding areas, the building becomes a landmark and a destination to which people are attracted to without spoiling the present landscape.

NATURAL SLOPE

The proposed building is low and follows the shape of the land to respect the local landscape, where the damage to the site is kept to the minimum. The buildings and

site are unified by the continuous floor covered with light and translucent roof so that the visitors feel themselves wandering around the site but without a strong boundary. Single-story structure also works to pack the existing land surface, where the visitors can look at the exhibits in a natural environment as much as possible.

BIG ONE ROOM

Inside consists of a big room. The visitors experience various activities in the spaces divided softly with small vertical interval and gentle slopes in the open landscape while feeling the atmosphere of the whole space.

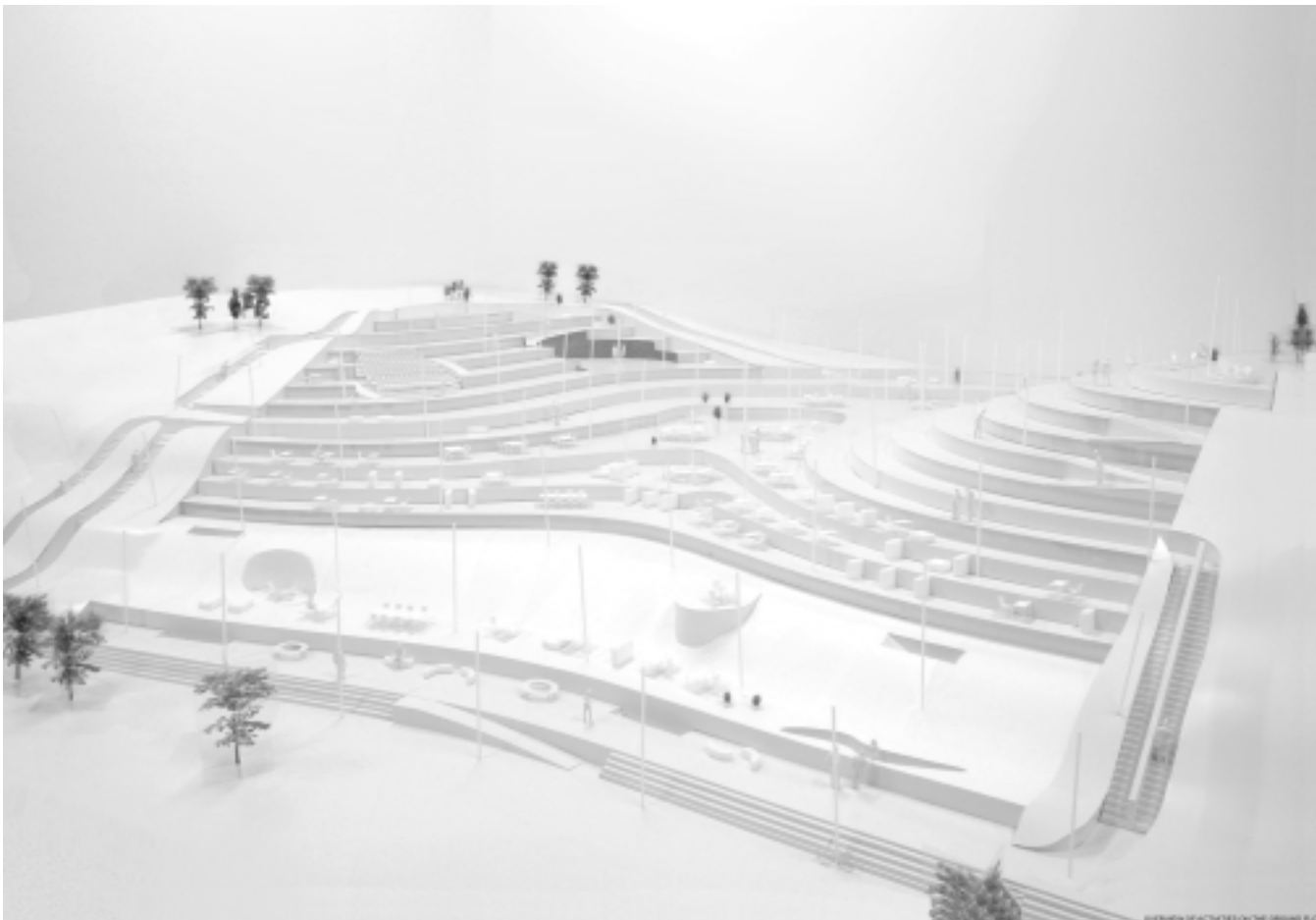



GROUND LEVEL PERSPECTIVE THROUGH THE WALKWAY FROM SOUTH

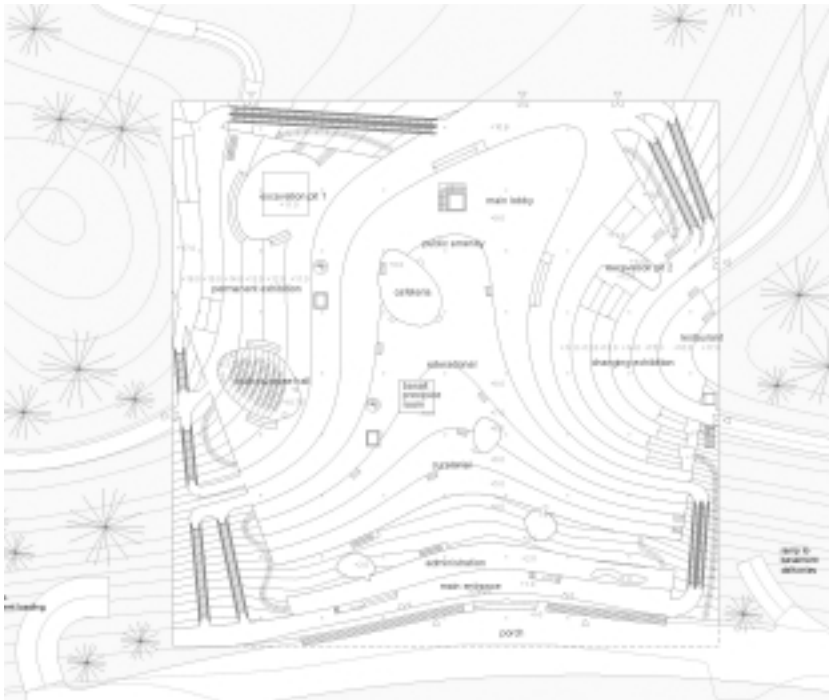

ENTRY
Visitors arrive to the Main Lobby located in the middle of the Jeongok Prehistory Museum through the main entrance of the south side of this building. This is the hearts of the building where one would receive general information, and get an overall perspective of the landscape inside.

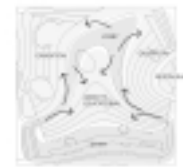

INTERNAL ZONES
Contours organize the open landscape into zones of activity. These zones are not physically partitioned so that atmospheres can blend into one another creating a relationship between the spaces and people inside.

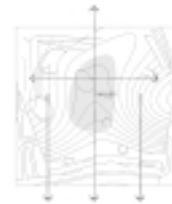

VIEWS
The visitors get wide view of the surrounding landscape from everywhere in the building. The Public Amenity Zone and Educational Zone are located in the 'valley' area surrounded by the hills on three sides so that people feel themselves comfortable during studying and their break.

